

FACILITY TECHNICAL PACKET



Facility Name:	FISHER THEATER
----------------	-----------------------

GENERAL INFORMATION

Facility Name:	IOWA STATE CENTER		
Mailing Address:	Scheman Building Suite 102, 1805 Center Drive, Ames, IA 50011		
Phone Number:	515-294-3347	Fax Number:	515-294-3349
E-mail Address:	iscinfo@iastate.edu	Website:	www.center.iastate.edu

CONTACT LIST

Title	Name	Phone Number	E-mail
Executive Director	Tammy Koolbeck	515-294-8809	tkool@iastate.edu
Director of Event Services, Theaters	Craig Wiebke	515-294-3384	cwiebke@iastate.edu
Director of Finance	Emily Ladewig	515-294-7698	eladewig@iastate.edu
Director of Marketing	Holly Olson	515-294-3566	hrolson@iastate.edu
Technical Director	Mike Broich	515-294-8808	broich@iastate.edu
Production Manager	Chris Campbell	515-294-2000	cjcampb@iastate.edu
Director of Operations	Tim Hinderks	515-294-5657	thinderk@iastate.edu
Director of Food and Beverage	Craig Spillman	515-294-2355	cspill@iastate.edu
Ticket Office Manager	Nick Kaizer	515-294-4454	kaizer@iastate.edu

DIRECTIONS TO IOWA STATE CENTER

<p>From Interstate 35, take the US Highway 30 West exit (Exit 111B). Proceed west on US 30 approximately three miles to the University Boulevard exit (Exit 146). This exit is also signed "Iowa State University".</p> <p>Stay to the right on the off ramp and follow University Boulevard north for approximately one mile. After winding past the football stadium, you will see a large arena, Hilton Coliseum, ahead on the left. Stephens Auditorium is the tall building directly west of the coliseum.</p> <p>Turn left on to Center Drive, the street immediately south of Hilton Coliseum, and proceed west to the loading dock doors on the south side of Stephens Auditorium.</p> <p>GPS Address: 1930 Center Drive, Ames, IA 50011</p>

DRIVING DISTANCES TO AMES

City & State	Mileage Distance	City & State	Mileage Distance
Des Moines, IA	35 miles	Cedar Rapids, IA	110 miles
Minneapolis, MN	215 miles	Chicago, IL	350 miles
Kansas City, MO	225 miles	St. Louis, MO	380 miles
Omaha, NE	170 miles	Denver, CO	700 miles

FACILITY TECHNICAL PACKET



TECHNICAL INFORMATION

PRODUCTION PERSONNEL

- Fisher Theater is not a union house, but is in the jurisdictional area of IATSE Local 67.
- Stagehands are non-union, professional hands and are experienced and well trained.
- Stagehands are directly responsible to the Iowa State Center Technical Director, who should be contacted for stagehand information.
- Mandatory meal break required after five hours.
- Specialized staff can be provided with ample prior notification.

STAGE SPECIFICATIONS

- Curtain line to back wall is 32'-6"
- Proscenium opening is 36'w x 18'h (Normal working height is 13' 6")
- Backstage wall-to-wall distance is 76' downstage, 50' upstage
- Clear height above stage floor is 33' down-stage, 24' up-stage, 18' over apron
- Stage floor is masonite over particle board, painted black
- Stage screws are permitted
- Stairs stage-right and stage-left to seating area
- Permanent orchestra pit can accommodate 25 musicians
- Orchestra pit can be covered with in-house equipment to extend stage deck
- Acoustical orchestra shell in-house (5 sections, 30' total width)
- Orchestra chairs, music stands and lights available
- A portable Marley dance floor is available with prior notification
- 9' Steinway piano available
- Piano tuner can be arranged through Iowa State Center Technical Director
- Rear projection: Rear wall to curtain line is 32'-6" (no screen in-house)
- Front projection: Booth to curtain line is 55'
- 12' x 9' Front projection screen available

LIGHTING

- Power: 3-phase, 400 amps/leg available 30' from center stage
 - House lighting mix position is located in booth at rear of house
 - Two FOH lighting beam positions
 - Dimming system consists of:
 - 186 2.4kw ETC Sensor dimmers with one dimmer per circuit
 - 12 2.4kw Portable pack w/150' power cable
 - ETC Express Control Board
 - DMX512 protocol
 - ETC Response Network Controller
 - Fisher Theater lighting instrumentation inventory is maintained in Stephens Auditorium. **Must be requested in advance.** Inventory consists of:
 - 36 Strand 40-degree Leko
 - 6 Strand 50-degree Leko
 - 6 Source-4 50-degree Leko
 - 46 Leko 750w 6x(9,12,16)
 - 36 Leko 750w 6x9
 - 20 1kw Fresnel
 - 5 FarCyc 3-cell, 1500w
 - 15 Mini-broads
 - 60 1kw Par 64 cans
- No permanent overhead electric battens
- Booms may not be placed in aisles

SOUND

- Theater has a permanent sound system
- Theater has excellent acoustics – typically, only minimal sound reinforcement is required.
- House sound console located in enclosed booth at rear of house. Booth window can be opened.
- Preferred road mix position: rear of house, elevated (seats are permanent and non-removable) or in house lighting/projection booth.
- Clear-Com intercom system available with eight stations

FACILITY TECHNICAL PACKET



FLY SYSTEM AND RIGGING

- Line-set hanging plot is included in this brochure
- Twenty under-hung, counterweighted line-sets
- Maximum arbor weight per set is 600 lbs.
- All battens are 42' long 1-1/2" black pipe
- House curtain is black velour traveler
- No grid over stage – limited hanging points available through false ceiling over apron. Any dead hangs or special rigging must be contracted through and approved by Iowa State Center Technical Director.
- Qualified riggers available with prior notification
- Soft Good Inventory:
 - 5 Sets of 8'W x 18'T legs
 - 5 Sets of 8'W x 24'T legs
 - 3 Borders 50'W x 8'T
 - 3 Borders 50'W x 6'T
 - 2 Borders 50'W x 4'T
 - 1 Main curtain consisting of 2 curtains each 26'W x 18'T (50% fullness)
 - 1 Blackout consisting of 2 pieces 21'W x 24'T
 - 1 Black sharks-tooth scrim 48'W x 20'T
 - 1 Natural color Cyc 41'W x 24'T

LOADING

- Loading dock door is 10'w x 10'h with clear loading and level approach
- One truck can unload at a time
- Stage is one floor up from dock via 12'w x 12'd x 7'h freight elevator
- Truck approach to the loading door is east off Beach Avenue, or west through parking lots
- Forklift available
- Free off-street parking available for trucks and buses

DRESSING ROOMS AND FACILITIES

- Two dressing rooms with toilets and showers located one level below stage
- The theater conforms to Actors' Equity Association Safe and Sanitary Code
- Access to stage is via steps from stage-left and stage-right
- No production telephone lines in-house – can be installed with advance notification
- Stage monitor and call system to dressing rooms
- Ticket office is located inside the main lobby.

TELEPHONE SERVICES

- Production telephone lines available through University phone system. Contact Stephens Auditorium Technical Director for availability and phone numbers.

HIGH-SPEED INTERNET SERVICES

- High-speed internet lines available through University system. WiFi is also available throughout theater.

OTHER PRODUCTION INFORMATION

- Cables permitted in aisles if taped or matted.
- Pyrotechnics are permitted only if operated by licensed technician. All pyrotechnics require prior approval to meet house regulations, and may require inspection by local fire authorities. Please advance all pyrotechnic information with the Fisher Theater Technical Director.
- Lasers require approval from the ISU Department of Environmental Health and Safety, and may be subject to inspection prior to usage. Please advance all laser information with the Fisher Theater Technical Director.
- Per University policy, use of Unmanned Aircraft Systems (UAS) or drones is not permitted without prior written approval from ISU Facilities Planning and Management and Iowa State Center. If approved, usage must comply with all aspects of ISU Unmanned Aircraft Systems policy as well as FAA regulations regarding the use of UAS.
- By law, Fisher Theater is a smoke-free facility. Smoking is not permitted anywhere in the building or on the grounds.



FISHER THEATER HANGING PLOT

Line-set #	US of Proscenium	High Trim	Low Trim
Hard Border	1' 6"	18' 0" +	
Traveler	2' 10"	32' 0"	
1	3' 10"	31' 1"	3' 10½"
2	4' 10"	30' 8½"	3' 5½"
3	5' 10"	30' 0"	3' 2½"
4	6' 10"	31' 5½"	4' 3"
5	7' 10"	31' 3"	4' 3½"
6	8' 10"	31' 11"	5' 5½"
7	9' 10"	31' 3"	5' 3"
8	10' 10"	31' 5 ½"	5' 8"
9	11' 10"	28' 10"	3' 7½"
10	12' 10"	30' 5½"	6' 3½"
11	13' 10"	30' ½"	5' 7"
12	14' 8"	30' 1½"	6' 8½"
13	15' 6"	29' 7"	6' 2"
14	17' 6"	28' 2"	6' 1"
15	19' 8"	19' 8"	4' 10"
16	21' 8"	27' 11"	7' 3"
17	23' 8"	27' 5"	7' 1"
18	25' 8"	26' 6"	6' 9"
19	27' 6"	24' 6"	5' 6"
20	29' 8"	23' 10½"	5' 7½"

FACILITY TECHNICAL PACKET



Iowa State Center
Iowa State University
Ames, Iowa

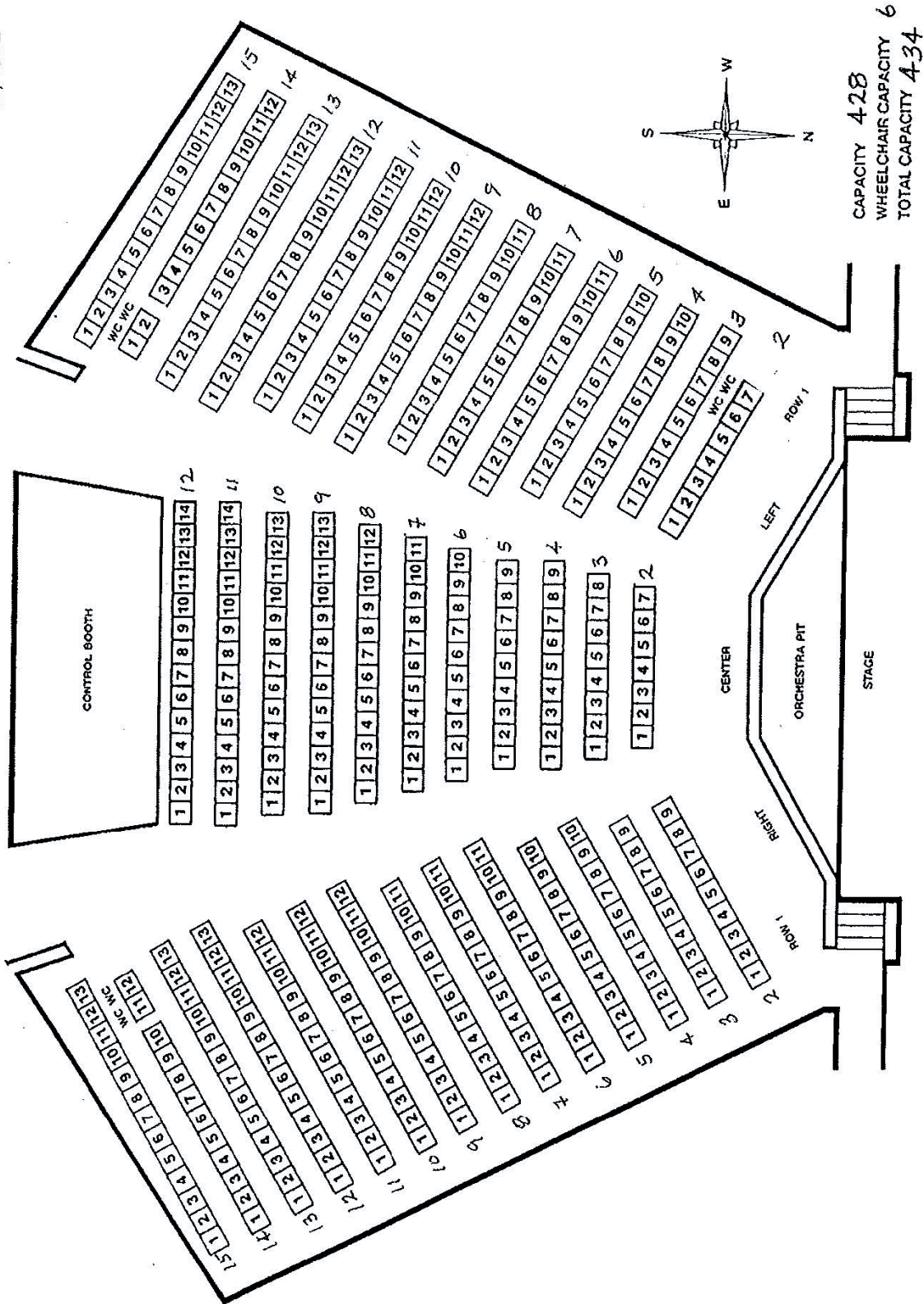

CAPACITY 428
WHEELCHAIR CAPACITY 6
TOTAL CAPACITY 434

FISHER THEATER SEATING CHART
NOT TO SCALE

FACILITY TECHNICAL PACKET



Iowa State Center
Iowa State University
Ames, Iowa

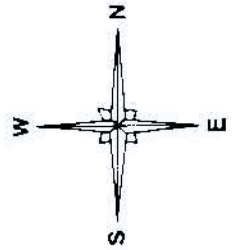
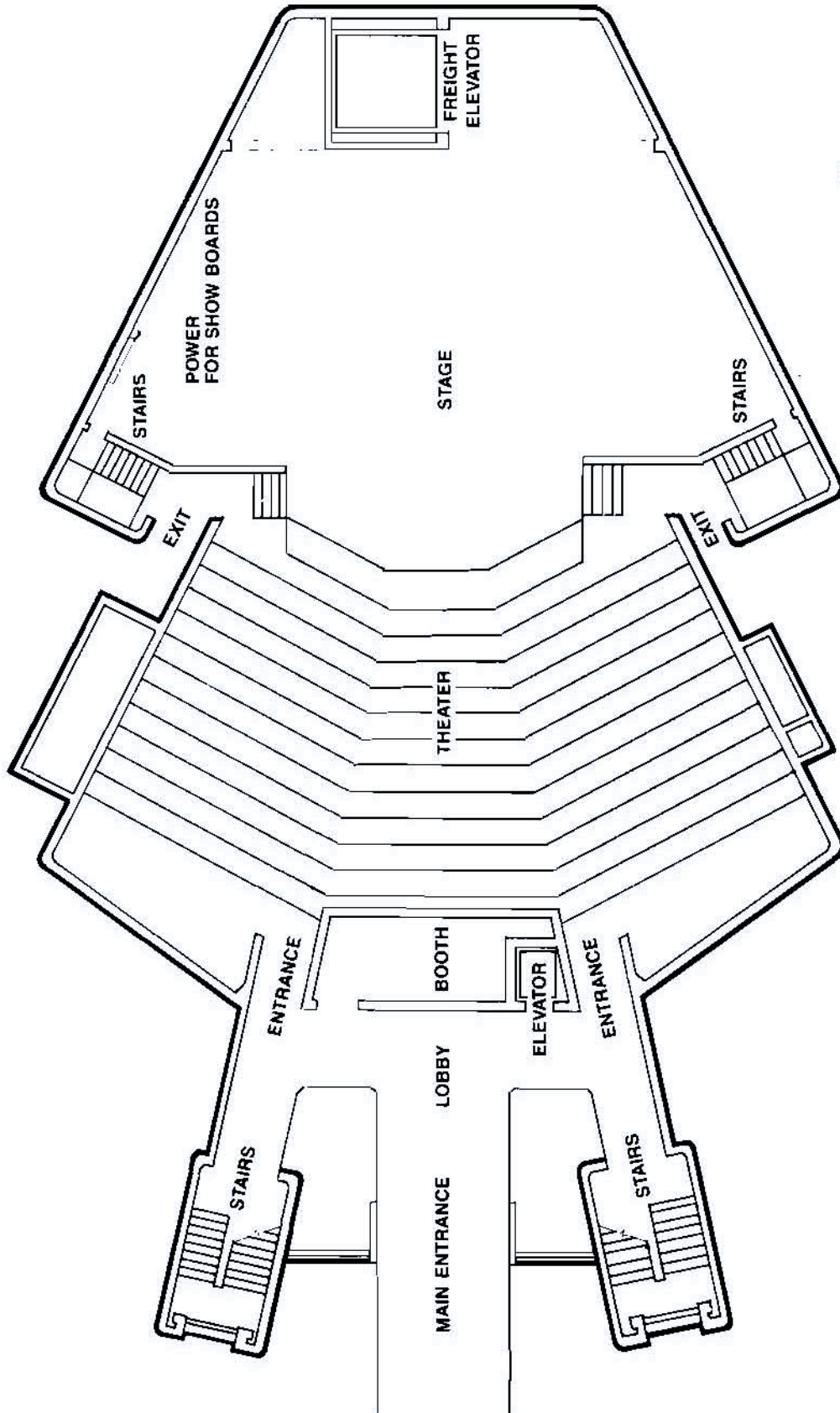

FISHER THEATER PLAN VIEW

SCALE 1" = 18' - 0"

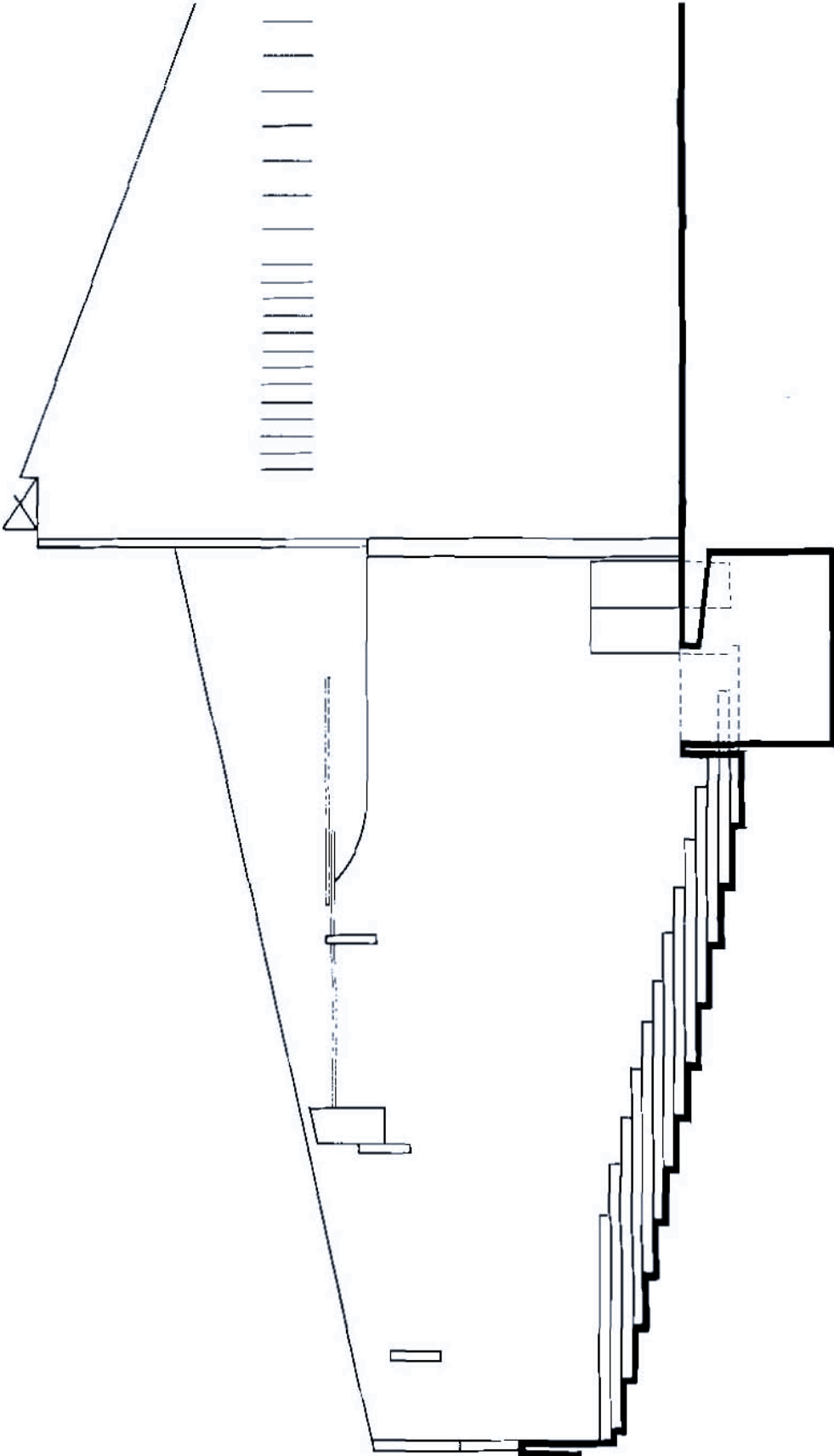

FISHER THEATER SECTION